

## PARTING & GROOVING CUTTER

PARTING & GROOVING TOOLHOLDERS

---

167,170

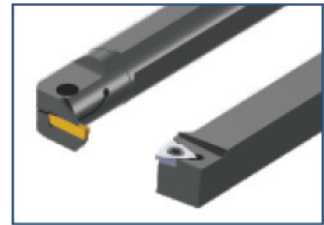

SOLID CARBIDE PARTING & GROOVING INSERTS

---

169,172



INDEXABLE GROOVING MILLS AND INSERTS

---

171



## EXTERNAL PARTING AND GROOVING TOOLHOLDERS FOR INSERT QE

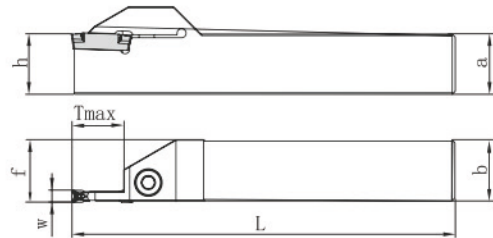
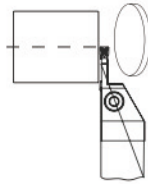
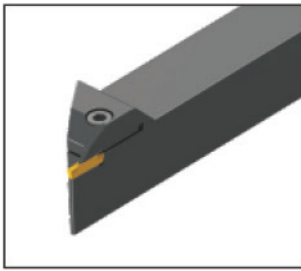

Order No.		Model		Size(mm)						Insert	Screw	Torx wrench
Right hand	Left hand	Right hand	Left hand	W	Tmax	a=h	b	f	L			
211-18-001	211-18-002	QE1616R02H08	QE1616L02H08	2	8	16	16	16.25	100	QE2.00	MS05016	S4
211-18-003	211-18-004	QE2020R02K08	QE2020L02K08	2	8	20	20	20.25	125	QE2.00	MS05016	S4
211-18-005	211-18-006	QE2525R02M08	QE2525L02M08	2	8	25	25	25.25	150	QE2.00	MS05016	S4
211-18-007	211-18-008	QE1616R03H16	QE1616L03H16	3	16	16	16	16.25	100	QE3.00	MS05016	S4
211-18-009	211-18-010	QE2020R03K16	QE2020L03K16	3	16	20	20	20.25	125	QE3.00	MS05016	S4
211-18-011	211-18-012	QE2525R03M16	QE2525L03M16	3	16	25	25	25.25	150	QE3.00	MS05016	S4
211-18-013	211-18-014	QE3225R03P16	QE3225L03P16	3	16	32	25	25.25	170	QE3.00	MS05016	S4
211-18-015	211-18-016	QE3232R03P16	QE3232L03P16	3	16	32	32	32.25	170	QE3.00	MS05016	S4
211-18-017	211-18-018	QE2020R04K16	QE2020L04K16	4	16	20	20	20.5	125	QE4.00	MS05016	S4
211-18-019	211-18-020	QE2525R04M16	QE2525L04M16	4	16	25	25	25.5	150	QE4.00	MS05016	S4
211-18-021	211-18-022	QE3225R04P16	QE3225L04P16	4	16	32	25	25.5	170	QE4.00	MS05016	S4
211-18-023	211-18-024	QE3232R04P16	QE3232L04P16	4	16	32	32	32.5	170	QE4.00	MS05016	S4
211-18-025	211-18-026	QE4040R04R16	QE4040L04R16	4	16	40	40	40.5	200	QE4.00	MS05016	S4
211-18-027	211-18-028	QE2525R05M20	QE2525L05M20	5	20	25	25	25.5	150	QE4.00	MS05016	S4
211-18-029	211-18-030	QE3225R05P20	QE3225L05P20	5	20	32	25	25.5	170	QE5.00	MS06020	S5
211-18-031	211-18-032	QE3232R05P20	QE3232L05P20	5	20	32	32	32.5	170	QE5.00	MS06020	S5
211-18-033	211-18-034	QE4040R05R20	QE4040L05R20	5	20	40	40	40.5	200	QE5.00	MS06020	S5

Insert not included

## INTERNAL GROOVING TOOLHOLDERS FOR INSERT QE

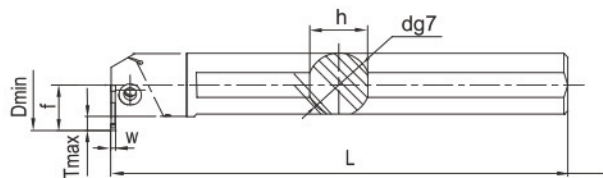
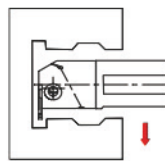

Order No.		Model		Size(mm)							Insert	Screw	Torx wrench
Right hand	Left hand	Right hand	Left hand	W	Tmax	d	h	f	Dmin	L			
221-18-001	221-18-002	S20Q-QER02-05	S20Q-QEL02-05	2	5	20	18	15	26	180	QE2.00	MS04012	S3
221-18-003	221-18-004	S25R-QER02-07	S25R-QEL02-07	2	7	25	23	19.5	33	200	QE2.00	MS05016	S4
221-18-005	221-18-006	S20Q-QER03-06	S20Q-QEL03-06	3	6	20	18	16	27	180	QE3.00	MS05016	S4
221-18-007	221-18-008	S25R-QER03-07	S25R-QEL03-07	3	7	25	23	19.5	33	200	QE3.00	MS05016	S4
221-18-009	221-18-010	S32S-QER03-09	S32S-QEL03-09	3	9	32	30	25	42	250	QE3.00	MS05016	S4
221-18-011	221-18-012	S25R-QER04-10	S25R-QEL04-10	4	10	25	23	22.5	36	200	QE4.00	MS05016	S4
221-18-013	221-18-014	S32S-QER04-11	S32S-QEL04-11	4	11	32	30	27	44	250	QE4.00	MS05016	S4
221-18-015	221-18-016	S40T-QER04-13	S40T-QEL04-13	4	13	40	37	33	54	300	QE4.00	MS05016	S4
221-18-017	221-18-018	S32S-QER05-11	S32S-QEL05-11	5	11	32	30	27	44	250	QE5.00	MS06020	S5
221-18-019	221-18-020	S40T-QER05-13	S40T-QEL05-13	5	13	40	37	33	54	300	QE5.00	MS06020	S5

Insert not included

FACE GROOVING TOOLHOLDERS FOR INSERT QE

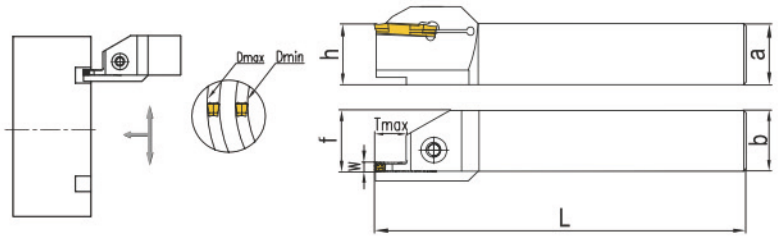
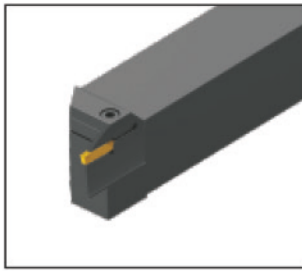

Order No.		Model		Size(mm)							Insert	Screw	Torx wrench
Right hand	Left hand	Right hand	Left hand	W	Tmax	D	a=h	b	f	L			
211-18-035	211-18-036	QE2020R02K08-M048060	QE2020L02K08-M048060	2	8	48-60	20	20	20.25	125	QE2.00	MS05016	S4
211-18-037	211-18-038	QE2020R02K08-H060075	QE2020L02K08-H060075	2	8	60-75	20	20	20.25	125	QE2.00	MS05016	S4
211-18-039	211-18-040	QE2020R02K08-H075100	QE2020L02K08-H075100	2	8	75-100	20	20	20.25	125	QE2.00	MS05016	S4
211-18-041	211-18-042	QE2525R02M08-M048060	QE2525L02M08-M048060	2	8	48-60	25	25	25.25	150	QE2.00	MS05016	S4
211-18-043	211-18-044	QE2525R02M08-H060075	QE2525L02M08-H060075	2	8	60-75	25	25	25.25	150	QE2.00	MS05016	S4
211-18-045	211-18-046	QE2525R02M08-H075100	QE2525L02M08-H075100	2	8	75-100	25	25	25.25	150	QE2.00	MS05016	S4
211-18-047	211-18-048	QE2020R03K16-H075100	QE2020L03K16-H075100	3	16	75-100	20	20	20.25	125	QE3.00	MS05016	S4
211-18-049	211-18-050	QE2525R03M16-H075100	QE2525L03M16-H075100	3	16	75-100	25	25	25.25	150	QE3.00	MS05016	S4
211-18-051	211-18-052	QE3232R03P16-H075100	QE3232L03P16-H075100	3	16	75-100	32	32	32.25	170	QE3.00	MS05016	S4
211-18-053	211-18-054	QE2020R04K16-M038048	QE2020L04K16-M038048	4	16	38-48	20	20	20.5	125	QE4.00	MS05016	S4
211-18-055	211-18-056	QE2020R04K16-M048060	QE2020L04K16-H048060	4	16	48-60	20	20	20.5	125	QE4.00	MS05016	S4
211-18-057	211-18-058	QE2020R04K16-H060075	QE2020L04K16-H060075	4	16	60-75	20	20	20.5	125	QE4.00	MS05016	S4
211-18-059	211-18-060	QE2020R04K16-H075100	QE2020L04K16-H075100	4	16	75-100	20	20	20.5	125	QE4.00	MS05016	S4
211-18-061	211-18-062	QE2020R04K16-H100140	QE2020L04K16-H100140	4	16	100-140	20	20	20.5	125	QE4.00	MS05016	S4
211-18-063	211-18-064	QE2020R04K16-H140240	QE2020L04K16-H140240	4	16	140-240	20	20	20.5	125	QE4.00	MS05016	S4
211-18-065	211-18-066	QE2020R04K16-M240480	QE2020L04K16-H240480	4	16	240-480	20	20	20.5	125	QE4.00	MS05016	S4
211-18-067	211-18-068	QE2525R04M16-H038048	QE2525L04M16-H038048	4	16	38-48	25	25	25.5	150	QE4.00	MS05016	S4
211-18-069	211-18-070	QE2525R04M16-H048060	QE2525L04M16-H048060	4	16	48-60	25	25	25.5	150	QE4.00	MS05016	S4
211-18-071	211-18-072	QE2525R04M16-H060075	QE2525L04M16-H060075	4	16	60-75	25	25	25.5	150	QE4.00	MS05016	S4
211-18-073	211-18-074	QE2525R04M16-H075100	QE2525L04M16-H075100	4	16	75-100	25	25	25.5	150	QE4.00	MS05016	S4
211-18-075	211-18-076	QE2525R04M16-H100140	QE2525L04M16-H100140	4	16	100-140	25	25	25.5	150	QE4.00	MS05016	S4
211-18-077	211-18-078	QE2525R04M16-H140240	QE2525L04M16-H140240	4	16	140-240	25	25	25.5	150	QE4.00	MS05016	S4
211-18-079	211-18-080	QE2525R04M16-H240480	QE2525L04M16-H240480	4	16	240-480	25	25	25.5	150	QE4.00	MS05016	S4
211-18-081	211-18-082	QE3232R04P16-H038048	QE3232L04P16-H038048	4	16	38-48	32	32	32.5	170	QE4.00	MS05016	S4
211-18-083	211-18-084	QE3232R04P16-H048060	QE3232L04P16-H048060	4	16	48-60	32	32	32.5	170	QE4.00	MS05016	S4
211-18-085	211-18-086	QE3232R04P16-H060075	QE3232L04P16-H060075	4	16	60-75	32	32	32.5	170	QE4.00	MS05016	S4
211-18-087	211-18-088	QE3232R04P16-H075100	QE3232L04P16-H075100	4	16	75-100	32	32	32.5	170	QE4.00	MS05016	S4
211-18-089	211-18-090	QE3232R04P16-H100140	QE3232L04P16-H100140	4	16	100-140	32	32	32.5	170	QE4.00	MS05016	S4
211-18-091	211-18-092	QE3232R04P16-H140240	QE3232L04P16-H140240	4	16	140-240	32	32	32.5	170	QE4.00	MS05016	S4
211-18-093	211-18-094	QE3232R04P16-H240480	QE3232L04P16-H240480	4	16	240-480	32	32	32.5	170	QE4.00	MS05016	S4
211-18-095	211-18-096	QE2525R05M20-H054070	QE2525L05M20-H054070	5	20	54-70	25	25	25.5	150	QE5.00	MS06020	S5
211-18-097	211-18-098	QE2525R05M20-H070095	QE2525L05M20-H070095	5	20	70-95	25	25	25.5	150	QE5.00	MS06020	S5
211-18-099	211-18-100	QE2525R05M20-H095130	QE2525L05M20-H095130	5	20	95-130	25	25	25.5	150	QE5.00	MS06020	S5
211-18-101	211-18-102	QE2525R05M20-H130180	QE2525L05M20-H130180	5	20	130-180	25	25	25.5	150	QE5.00	MS06020	S5
211-18-103	211-18-104	QE2525R05M20-H180000	QE2525L05M20-H180000	5	20	180-	25	25	25.5	150	QE5.00	MS06020	S5
211-18-105	211-18-106	QE3232R05P20-H054070	QE3232L05P20-H054070	5	20	54-70	32	32	32.5	170	QE5.00	MS06020	S5
211-18-107	211-18-108	QE3232R05P20-H070095	QE3232L05P20-H070095	5	20	70-95	32	32	32.5	170	QE5.00	MS06020	S5
211-18-109	211-18-110	QE3232R05P20-H095130	QE3232L05P20-H095130	5	20	95-130	32	32	32.5	170	QE5.00	MS06020	S5
211-18-111	211-18-112	QE3232R05P20-H130180	QE3232L05P20-H130180	5	20	130-180	32	32	32.5	170	QE5.00	MS06020	S5
211-18-113	211-18-114	QE3232R05P20-H180000	QE3232L05P20-H180000	5	20	180-	32	32	32.5	170	QE5.00	MS06020	S5

Insert not included

## SOLID CARBIDE PARTING &amp; GROOVING INSERTS QE

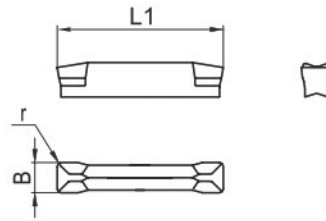

Order No.	Model	Grade	Application	Insert size (mm)		
				L1	B	r
311-20-001	QE2.00-EMF	EC2120	steel and cast iron	16	2	0.2
311-20-002	QE3.00-EMF	EC2120	steel and cast iron	20	3	0.3
311-20-003	QE4.00-EMF	EC2120	steel and cast iron	20	4	0.4
311-20-004	QE5.00-EMF	EC2120	steel and cast iron	26	5	0.4
321-20-001	QE2.00-EMF	EC4130	stainless steel	16	2	0.2
321-20-002	QE3.00-EMF	EC2120	stainless steel	20	3	0.3
321-20-003	QE4.00-EMF	EC2120	stainless steel	20	4	0.4
321-20-004	QE5.00-EMF	EC2120	stainless steel	26	5	0.4

## GRE EXTERNAL GROOVING TOOLHOLDS FOR INSERT TN1635

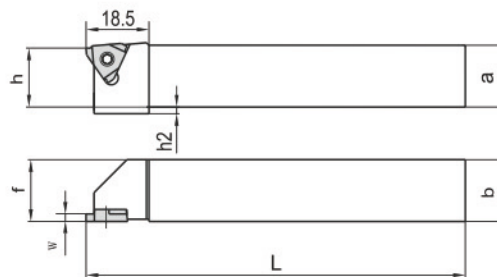
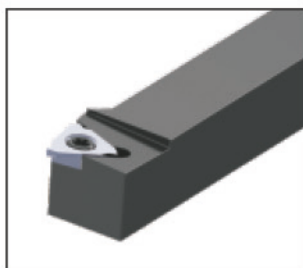

Order No.		Model		Size(mm)					Insert	Screw	Torx wrench
Right hand	Left hand	Right hand	Left hand	a=h	b	h2	f	L			
211-19-001	211-19-002	GRE.R 1616K TN16	GRE.L 1616K TN16	16	16	-	16	125	TN1635...	L60 M3.5x8.8	T15
211-19-003	211-19-004	GRE.R 2020K TN16	GRE.L 2020K TN16	20	20	-	20	125	TN1635...	L60 M3.5x8.8	T15

Insert not included.

## GRI INTERNAL GROOVING TOOLHOLDS FOR INSERT TN1635

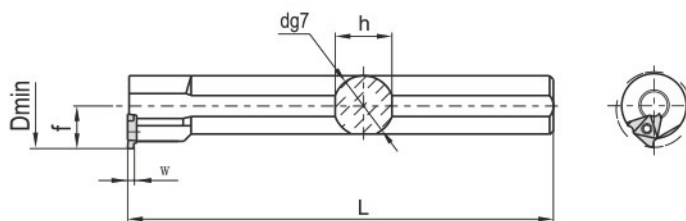
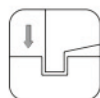

Order No.		Model		Size(mm)					Insert	Screw	Torx wrench
Right hand	Left hand	Right hand	Left hand	d	h	f	Dmin	L			
211-19-005	211-19-006	GRI.R S20M TN16	GRI.L S20M TN16	20	18	13	25	150	TN1635...	L60 M3.5x8.8	T15
211-19-007	211-19-008	GRI.R S25Q TN16	GRI.L S25Q TN16	25	23	17	32	180	TN1635...	L60 M3.5x8.8	T15

Insert not included.

## GRV INTERNAL GROOVING TOOLHOLDS FOR INSERT TN1635

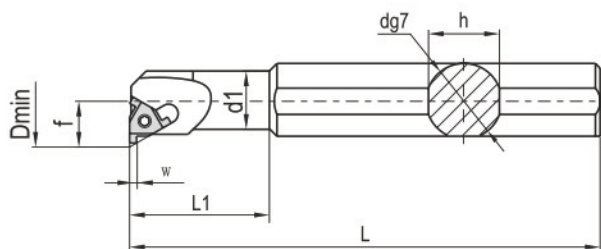

Order No.		Model		Size(mm)							Insert	Screw	Torx wrench
Right hand	Left hand	Right hand	Left hand	d	d1	h	f	Dmin	L1	L			
211-19-009	211-19-010	GRV.R S20Q.20 TN16	GRV.L S20Q.20 TN16	20	16	18	11.5	20	40	180	TN1635...V	L60 M3.5x8.8	T15

## SHANK STYLE INDEXABLE GROOVING MILLS FOR INSERT TN1635

- Suitable for cutting both internal and external groove.
- Shank according to DIN1835B.
- Right hand cutting.

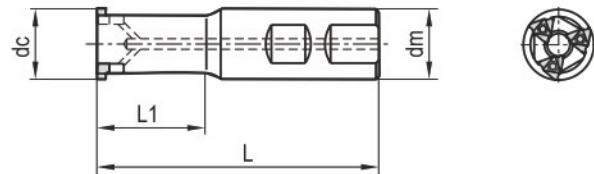
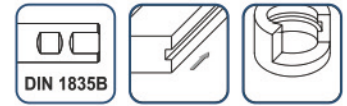

Order No.	Model	Size(mm)				No.of teeth	Insert	Screw	Torx wrench	Weight
		dc	dm	L1	L					
241-19-001	CMT-20TN16	20	20	30	90	1	TN1635R	L60-M3.5x8.8A	T15	0.2
241-19-002	CMT-25TN16	25	25	40	105	1	TN1635R	L60-M3.5x8.8A	T15	0.3
241-19-003	CMT-32TN16	32	32	55	125	3	TN1635R	L60-M3.5x8.8A	T15	0.5
241-19-004	CMT-40TN16	40	32	70	135	3	TN1635R	L60-M3.5x8.8A	T15	0.8

Insert not included

## INDEXABLE GROOVING MILLS FOR INSERT TN1635

- Suitable for cutting both internal and external groove.
- Right hand cutting.

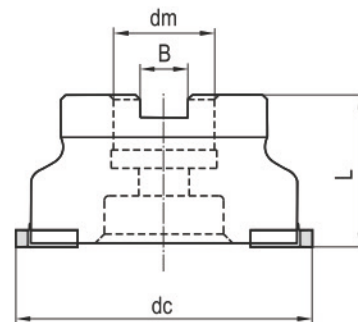
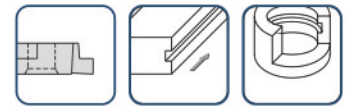

Order No.	Model	Size(mm)				No.of teeth	Insert	Screw	Torx wrench	Weight
		dc	dm	B	L					
231-19-001	FMT-51TN16	51	22	10.4	40	4	TN1635R..	L60-M3.5x8.8A	WT15	0.4
231-19-002	FMT-63TN16	63	22	10.4	40	6	TN1635R..	L60-M3.5x8.8A	WT15	0.6
231-19-003	FMT-80TN16	80	27	12.4	50	6	TN1635R..	L60-M3.5x8.8A	WT15	0.9

Insert not included

# PARTING & GROOVING CUTTER

## SOLID CARBIDE GROOVING INSERT TN1635

Note:

- For GRI internal groove cutting, left hand toolholder must choose left hand insert and right hand toolholder must choose right hand insert.

Note:

- For GRE External groove cutting, left hand toolholder must choose right hand insert and right hand toolholder must choose left hand insert.

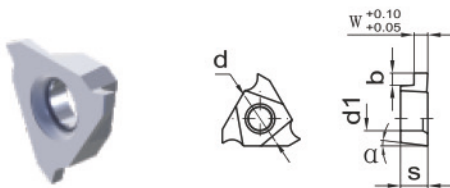
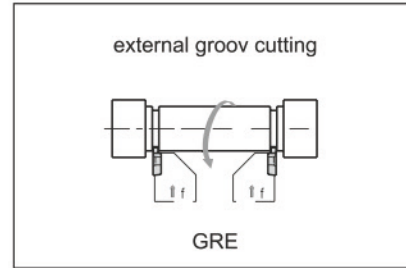
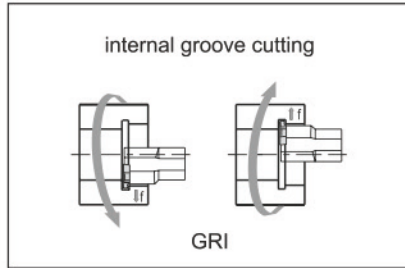

Right hand

Order No.	Model	Size(mm)						Grade	Application
		w	b	d	d1	s	$\alpha$		
311-21-001	TN1635R110	1.1	0.9	9.525	3.8	3.5	0°	EP2125	steel and INOX
311-21-003	TN1635R130	1.3	1.3	9.525	3.8	3.5	0°	EP2125	steel and INOX
311-21-005	TN1635R160	1.6	1.4	9.525	3.8	3.5	0°	EP2125	steel and INOX
311-21-007	TN1635R185	1.85	1.7	9.525	3.8	3.5	0°	EP2125	steel and INOX
311-21-009	TN1635R215	2.15	2	9.525	3.8	3.5	0°	EP2125	steel and INOX
311-21-011	TN1635R265	2.65	2.2	9.525	3.8	3.5	0°	EP2125	steel and INOX
331-21-001	TN1635R110	1.1	0.9	9.525	3.8	3.5	0°	EP3125	cast iron
331-21-003	TN1635R130	1.3	1.3	9.525	3.8	3.5	0°	EP3125	cast iron
331-21-005	TN1635R160	1.6	1.4	9.525	3.8	3.5	0°	EP3125	cast iron
331-21-007	TN1635R185	1.85	1.7	9.525	3.8	3.5	0°	EP3125	cast iron
331-21-009	TN1635R215	2.15	2	9.525	3.8	3.5	0°	EP3125	cast iron
331-21-011	TN1635R265	2.65	2.2	9.525	3.8	3.5	0°	EP3125	cast iron
341-21-001	TN1635R110	1.1	0.9	9.525	3.8	3.5	0°	EW3125	Al-alloy
341-21-003	TN1635R130	1.3	1.3	9.525	3.8	3.5	0°	EP3125	Al-alloy
341-21-005	TN1635R160	1.6	1.4	9.525	3.8	3.5	0°	EP3125	Al-alloy
341-21-007	TN1635R185	1.85	1.7	9.525	3.8	3.5	0°	EP3125	Al-alloy
341-21-009	TN1635R215	2.15	2	9.525	3.8	3.5	0°	EP3125	Al-alloy
341-21-011	TN1635R265	2.65	2.2	9.525	3.8	3.5	0°	EP3125	Al-alloy

Left hand

Order No.	Model	Size(mm)						Grade	Application
		w	b	d	d1	s	$\alpha$		
311-21-002	TN1635L110	1.1	0.9	9.525	3.8	3.5	0°	EP2125	steel and INOX
311-21-004	TN1635L130	1.3	1.3	9.525	3.8	3.5	0°	EP2125	steel and INOX
311-21-006	TN1635L160	1.6	1.4	9.525	3.8	3.5	0°	EP2125	steel and INOX
311-21-008	TN1635L185	1.85	1.7	9.525	3.8	3.5	0°	EP2125	steel and INOX
311-21-010	TN1635L215	2.15	2	9.525	3.8	3.5	0°	EP2125	steel and INOX
311-21-012	TN1635L265	2.65	2.2	9.525	3.8	3.5	0°	EP2125	steel and INOX
331-21-002	TN1635L110	1.1	0.9	9.525	3.8	3.5	0°	EP3125	cast iron
331-21-004	TN1635L130	1.3	1.3	9.525	3.8	3.5	0°	EP3125	cast iron
331-21-006	TN1635L160	1.6	1.4	9.525	3.8	3.5	0°	EP3125	cast iron
331-21-008	TN1635L185	1.85	1.7	9.525	3.8	3.5	0°	EP3125	cast iron
331-21-010	TN1635L215	2.15	2	9.525	3.8	3.5	0°	EP3125	cast iron
331-21-012	TN1635L265	2.65	2.2	9.525	3.8	3.5	0°	EP3125	cast iron
341-21-002	TN1635L110	1.1	0.9	9.525	3.8	3.5	0°	EW3125	Al-alloy
341-21-004	TN1635L130	1.3	1.3	9.525	3.8	3.5	0°	EP3125	Al-alloy
341-21-006	TN1635L160	1.6	1.4	9.525	3.8	3.5	0°	EP3125	Al-alloy
341-21-008	TN1635L185	1.85	1.7	9.525	3.8	3.5	0°	EP3125	Al-alloy
341-21-010	TN1635L215	2.15	2	9.525	3.8	3.5	0°	EP3125	Al-alloy
341-21-012	TN1635L265	2.65	2.2	9.525	3.8	3.5	0°	EP3125	Al-alloy

## SOLID CARBIDE GROOVING INSERT TN1635...V

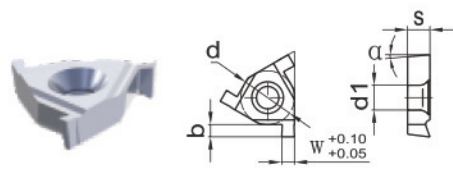
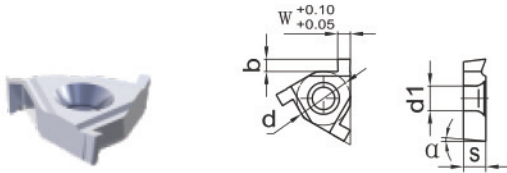
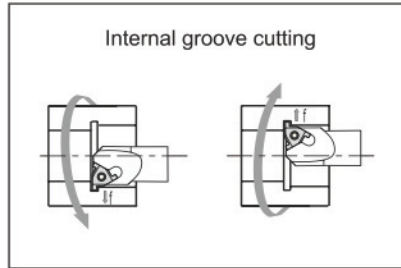

Right hand

Order No.	Model	Size(mm)						Grade	Application
		w	b	d	d1	s	$\alpha$		
311-21-013	TN1635R110-V	1.1	1.3	9.525	3.8	3.5	0°	EP2125	steel and INOX
311-21-015	TN1635R130-V	1.3	1.6	9.525	3.8	3.5	0°	EP2125	steel and INOX
311-21-017	TN1635R160-V	1.6	1.85	9.525	3.8	3.5	0°	EP2125	steel and INOX
311-21-019	TN1635R185-V	1.85	1.85	9.525	3.8	3.5	0°	EP2125	steel and INOX
311-21-021	TN1635R215-V	2.15	1.85	9.525	3.8	3.5	0°	EP2125	steel and INOX
331-21-013	TN1635R110-V	1.1	0.9	9.525	3.8	3.5	0°	EP3125	cast iron
331-21-015	TN1635R130-V	1.3	1.3	9.525	3.8	3.5	0°	EP3125	cast iron
331-21-017	TN1635R160-V	1.6	1.4	9.525	3.8	3.5	0°	EP3125	cast iron
331-21-019	TN1635R185-V	1.85	1.7	9.525	3.8	3.5	0°	EP3125	cast iron
331-21-021	TN1635R215-V	2.15	2	9.525	3.8	3.5	0°	EP3125	cast iron
341-21-013	TN1635R110-V	1.1	0.9	9.525	3.8	3.5	0°	EW3125	Al-alloy
341-21-015	TN1635R130-V	1.3	1.3	9.525	3.8	3.5	0°	EP3125	Al-alloy
341-21-017	TN1635R160-V	1.6	1.4	9.525	3.8	3.5	0°	EP3125	Al-alloy
341-21-019	TN1635R185-V	1.85	1.7	9.525	3.8	3.5	0°	EP3125	Al-alloy
341-21-021	TN1635R215-V	2.15	2	9.525	3.8	3.5	0°	EP3125	Al-alloy

Left hand

Order No.	Model	Size(mm)						Grade	Application
		w	b	d	d1	s	$\alpha$		
311-21-014	TN1635L110-V	1.1	0.9	9.525	3.8	3.5	0°	EP2125	steel and INOX
311-21-016	TN1635L130-V	1.3	1.3	9.525	3.8	3.5	0°	EP2125	steel and INOX
311-21-018	TN1635L160-V	1.6	1.4	9.525	3.8	3.5	0°	EP2125	steel and INOX
311-21-020	TN1635L185-V	1.85	1.7	9.525	3.8	3.5	0°	EP2125	steel and INOX
311-21-022	TN1635L215-V	2.15	2	9.525	3.8	3.5	0°	EP2125	steel and INOX
331-21-014	TN1635L110-V	1.1	0.9	9.525	3.8	3.5	0°	EP3125	cast iron
331-21-016	TN1635L130-V	1.3	1.3	9.525	3.8	3.5	0°	EP3125	cast iron
331-21-018	TN1635L160-V	1.6	1.4	9.525	3.8	3.5	0°	EP3125	cast iron
331-21-020	TN1635L185-V	1.85	1.7	9.525	3.8	3.5	0°	EP3125	cast iron
331-21-022	TN1635L215-V	2.15	2	9.525	3.8	3.5	0°	EP3125	cast iron
341-21-014	TN1635L110-V	1.1	0.9	9.525	3.8	3.5	0°	EW3125	Al-alloy
341-21-016	TN1635L130-V	1.3	1.3	9.525	3.8	3.5	0°	EP3125	Al-alloy
341-21-018	TN1635L160-V	1.6	1.4	9.525	3.8	3.5	0°	EP3125	Al-alloy
341-21-020	TN1635L185-V	1.85	1.7	9.525	3.8	3.5	0°	EP3125	Al-alloy
341-21-022	TN1635L215-V	2.15	2	9.525	3.8	3.5	0°	EP3125	Al-alloy